

**Dimensioni** *Dimensions* [mm]

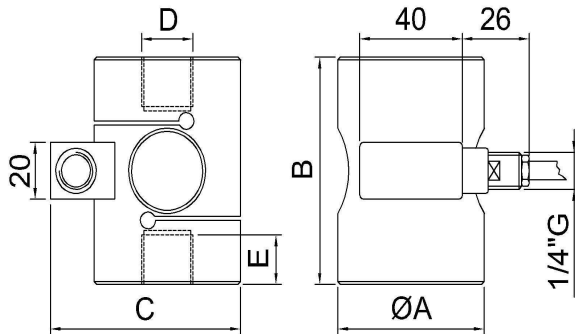

CODE	LOAD	ØA	B	C	D	E
CTCE57350K5	350 kg	57	80	74.5	M20X1.5	17
CTCE57500K5	500 kg					
CTCE571TK5	1 t					
CTCE572T55	2.5 t					
CTCE575T5	5 t					
CTCE825T5	5 t	82	110	102	M30X2	20
CTCE827T55	7.5 t					
CTCE8210T5	10 t					
CTCE8220T5	20 t					

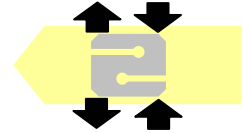
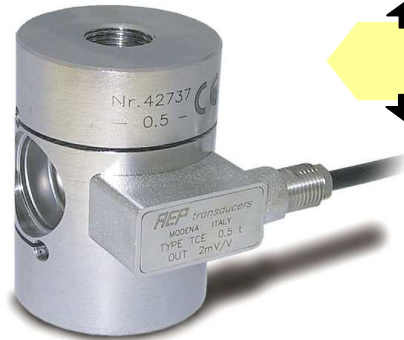

**RoHS**  
COMPLIANCE

≤±0.03%

Linearità - Isteresi  
Linearity - Hysteresis

Facile applicazione  
Applicazioni dinamiche

Easy application  
Dynamic applications

**OPZIONE :**  II 2 G Ex ib IIC T6  
**OPTION :** II 2 D Ex ibD 21 T70°C

Certificato: TÜV 06 ATEX 553026 X  
Certificate: TÜV 06 ATEX 553026 X

**Dati Tecnici**



**Technical Data**

CARICO NOMINALE	NOMINAL LOAD	350 - 500 kg 1 - 2.5 - 5 <sup>(1)</sup> - 7.5 - 10 - 20 t
SENSIBILITA' NOMINALE	NOMINAL SENSITIVITY	2mV/V
TOLLERANZA DI CALIBRAZIONE	SENSITIVITY TOLERANCE	≤ ±0.1%
EFFETTO TEMPERATURA (10 °C)	TEMPERATURE EFFECT (10 °C)	
a) sullo zero	a) on zero	≤ ±0.030%
b) sulla sensibilità	b) on sensitivity	≤ ±0.011%
LINEARITA'	LINEARITY	≤ ±0.03%
ISTERESI	HYSTERESIS	≤ ±0.03%
RIPETIBILITA'	REPEATABILITY	≤ ±0.01%
RESISTENZA DI INGRESSO	INPUT RESISTANCE	420 ± 20Ω
RESISTENZA DI USCITA	OUTPUT RESISTANCE	350 ± 2Ω
RESISTENZA DI ISOLAMENTO	INSULATION RESISTANCE	>5 GΩ
BILANCIAMENTO DI ZERO	ZERO BALANCE	≤ ±1%
ALIMENTAZIONE DI RIFERIMENTO	RECOMMENDED SUPPLY VOLTAGE	10 V
ALIMENTAZIONE NOMINALE	NOMINAL SUPPLY VOLTAGE	1-15 V
ALIMENTAZIONE MAX.	MAXIMUM SUPPLY VOLTAGE	18 V
VALORI MECCANICI LIMITE RIFERITI AL CARICO NOMINALE :	MECHANICAL LIMIT VALUES REFERRED TO NOMINAL LOAD :	
a) carico di servizio	a) service load	120%
b) carico limite	b) max permissible load	150%
c) carico di rottura	c) breaking load	>300%
d) massimo carico trasversale	d) max transverse load	50%
e) carico dinamico limite	e) max permissible dynamic load	50%
FRECCIA MAX. AL CARICO NOMINALE	DISPLACEMENT AT NOMINAL LOAD	~ 0.3 mm

TEMPERATURA DI RIFERIMENTO CAMPO NOMINALE DI TEMPERATURA TEMPERATURA DI ESERCIZIO TEMPERATURA DI STOCCAGGIO	REFERENCE TEMPERATURE TEMPERATURE NOMINAL RANGE SERVICE TEMPERATURE STORAGE TEMPERATURE	+23°C -10/+40 °C -20/+70 °C -20/+80 °C
PESO CLASSE DI PROTEZIONE (EN 60529) MATERIALE DELLA CELLA LUNGHEZZA CAVO	WEIGHT PROTECTION CLASS (EN 60529) EXECUTION MATERIAL CABLE LENGTH	Ø57:~1.5 kg Ø82:~4.2 kg 20t:~5kg IP67 Acciaio Inox / Stainless Steel 5 m
TESTE A SNODO SFERICO CONSIGLIATE	RECOMMENDED KNUCKLE JOINTS	DURBAL EM20 - EM30

<sup>(1)</sup> La cella di carico Ø57 viene garantita solo per applicazioni in **COMPRESSIONE**.  
The load cell Ø57 is guaranteed for applications in **COMPRESSION** only.

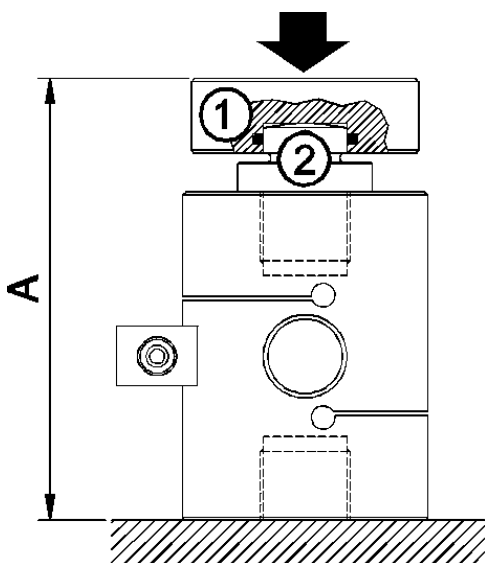
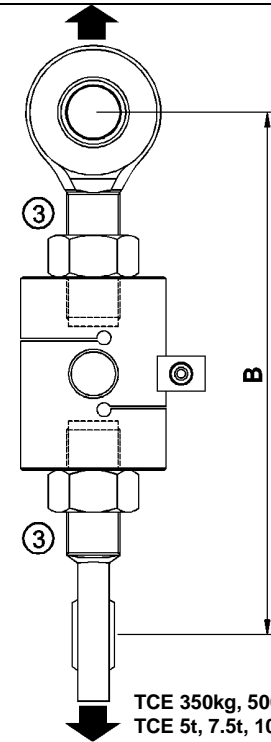
## Applicazioni Applications

COMPRESSIONE COMPRESSION	TRAZIONE TENSION
 <p>TCE 350kg, 500kg, 1t, 2.5t, 5t    A = 117 mm TCE 5t, 7.5t, 10t                    A = 149 mm TCE 20t                                    A = 198 mm</p>	 <p>TCE 350kg, 500kg, 1t, 2.5t    B = ~200mm TCE 5t, 7.5t, 10t                    B = ~300mm TCE 20t                                    B = ~420mm</p>
<p><b>ATTENZIONE:</b> Il peso del cavo può influire la misura, è pertanto consigliabile posizionarlo nella zona fissa dalla parte opposta al carico.</p> 	<p><b>WARNING:</b> Cable weight can influence measurement, it is therefore recommended to place it at the opposite site of the load.</p> 

**Accessori Accessories**
**A**

TCE:	CODE:		ACCESSORIES (optional):	ACCESSORI (opzionali):
350kg, 500kg 1t, 2.5t, 5t	CTIC22	①	Loading head.	Testa di carico
	CTS25M20	②	Spherical loading head.	Testa di carico sferica.
	CACCEM20	③	Knuckle joints.	Teste a snodo sferico
5t, 7.5t, 10t	CTIC28	①	Loading head.	Testa di carico
	CTS45M30	②	Spherical loading head.	Testa di carico sferica.
	CACCEM30	③	Knuckle joints.	Teste a snodo sferico
20 t	CTIC35	①	Loading head.	Testa di carico
	CTS62M42	②	Spherical loading head.	Testa di carico sferica.
	CACCEM42	③	Knuckle joints.	Teste a snodo sferico

**Collegamenti Elettrici Electrical Connections**

Cavo schermato PVC 105°C, Ø 5.2mm a 4 conduttori Ø 0.35mm<sup>2</sup> stagnati.

PVC 105°C shielded cable, Ø 5.2mm with 4 tinned Ø 0.35mm<sup>2</sup> conductors.

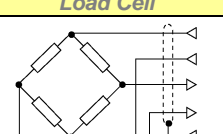
Load Cell	OUTPUT	CABLE	CAVO
	EXCITATION+ EXCITATION - OUTPUT+ OUTPUT-	Red Black White Yellow Shield*	Rosso Nero Bianco Giallo Schermo*

\* Collegato al corpo della cella di carico. Connected to the body of the load cell.